

## FOR OUR GUESTS

---

We are glad you chose to worship with us today! We want to make your experience with us as easy and enjoyable as possible. The following information will help you to know what to expect today.

### Please take advantage of our children's programs:

#### **Nursery (ages 0 through 2 yrs.)**

A staffed, teaching nursery is located out the auditorium doors to the right.

#### **Jesus' Farm (Ages 3 yrs. - K)**

Jesus Farm is our pre-school program, offered during both hours, to help children know that God loves & cares for us. Every activity is geared to the child's learning level. It is located out the auditorium doors to the left. Your child may be checked in at the wagon.

#### **rEVOLVe (Grades 1 - 5)**

rEVOLVe is our elementary-age program located in the lower level of the fellowship hall. Bring your child down at 9:00 for Sunday School. Children will head to the lower level and enter a time of worship & an environment to develop a relationship with Jesus Christ through different activities.

**The Offering** - It is a privilege to give back to God a portion of the material blessings He has given us. Offering boxes are located on the walls at the back of the auditorium or you can give online @ [ripleycoc.com](http://ripleycoc.com).

**Communion** - We choose to offer the Lords' Supper each Sunday for all Christians to share. This is done to provide an opportunity to obey Christ to commune "in remembrance" of His death on the cross. Use this quiet time to draw close to the sacrificial Savior. Emblems can be picked up at the table in the foyer.

**Decision and Dedication** - Times for public responses to God are included in our worship. If you believe that Jesus is the Son of God, has the power to be your Savior, and has the right to be your Lord, this is an invitation for you to come to the front at the invitation song to announce your belief publicly and to

accept Christ by immersion in water (baptism). If you are an immersed believer in Jesus, and desire to be an active member of this body of believers, then come to affirm your faith publicly and express that desire. Responses for rededication and prayer are also encouraged by coming to the front at the invitation song.

If you would like further information about either of these decisions, feel free to schedule an appointment with one of our staff members. Individuals may make these decisions throughout the week and need not take place in the worship service.

*If you need additional information or assistance, please ask an usher or greeter. They are here to assist you.*



## Welcome to Summer School

### Ripley Church of Christ

9:00 am Sunday School

10:15 am Worship

Ph. 330-567-2320

[www.ripleycoc.com](http://www.ripleycoc.com)

For more detailed information about our church, service opportunities or ministries, stop by our welcome center or visit us on the web. You'll find access to sermons, resources, calendar, and more.



Aug 7, 2022

Tom Benter  
Senior Minister

Mike South  
Youth Minister

Jeremiah Stivers  
Associate Minister

Ariel Stivers  
Children's Ministry Coordinator

# Sermon Notes

## Between A Rock & A Hard Place



Genesis 32:17-31

Today we look at the life of Jacob one more time. We pick up with an odd episode that begins after he deceived his father, Isaac. Jacob was not the finest character you could ever meet. He was a liar, a cheat, and a swindler.

### BACKGROUND - Genesis 29:16-20

Since Jacob was in love with Rachel, he told her father, "I'll work for you for seven years if you'll give me Rachel, your younger daughter, as my wife." "Agreed!" Laban replied. .... But his love for her was so strong that it seemed to him but a few days.

A brief spiritual lesson: Leah: L\_\_\_\_\_ Rachel: G\_\_\_\_\_

Both men are m\_\_\_\_\_ and m\_\_\_\_\_.

### I. Jacob's R\_\_\_\_\_ Genesis 31:20-21

\_\_\_\_\_ --> \_\_\_\_\_ <-- \_\_\_\_\_

What do you do when nothing seems to work and you don't know what to do?

### II. Jacob's R\_\_\_\_\_

#### 1. He p\_\_\_\_\_ the confrontation

After delivering the message, the messengers returned to Jacob and reported, "We met your brother, Esau, and he is already on his way to meet you—with an army of 400 men!" - Genesis 32:6

#### 2. He p\_\_\_\_\_ Genesis 32:17-31

He was trying to p\_\_\_\_\_ his brother ...This left Jacob all alone...

#### 3. He p\_\_\_\_\_

- Jacob was f\_\_\_\_\_
- Jacob tried to f\_\_\_\_\_ God
- Jacob was a f\_\_\_\_\_
- Jacob became a man of f\_\_\_\_\_
- Jacob became a man of f\_\_\_\_\_

### III. Jacob's R\_\_\_\_\_

"What is your name?" the man asked. - Genesis 32:27

The problem is s\_\_\_\_\_ i\_\_\_ y\_\_\_ that needs to change

### CONCLUSION

D\_\_\_\_\_ is the fuel behind the praying Jacob did that night.

If and when you find yourself between a rock and a hard place — the direction God's trying to get you to go isn't north, south, east, or west. The direction He has for you is U\_\_\_\_\_!!!

Is anyone among you in trouble? Let them pray. Is anyone happy? Let them sing songs of praise. - James 5:13 (NIV)

\*Scripture references taken from the New Living Translation unless noted otherwise.

## This Week

Today:	9:00 a	Sunday School
	10:15 a	Worship
	6 :00 p	Launch Fall Kickoff
Mon-Sat:		Holmes Co Fair
Wed:	7:00 p	Women's Bible Study

### ABF Classes / Locations

#### 9:00a

Adult Study, Acts F3  
 Youth Sunday School, Basement  
 Women's Class, *Next Door Savior* by Max Lucado., Conf. Room  
 College / Young Adults , Choir Room  
 Ladies' Class; *She Works His Way*, F2

#### 6-8p Sunday

Ladies' Study: *Gospel of Mark*, Conf. Room  
(not meeting in June)

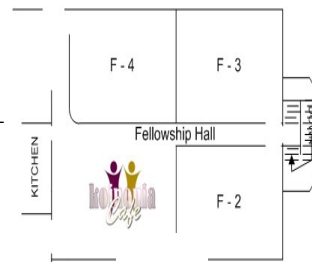

July 31	Giving \$ 8,842.74	Budget \$7,692.31
	<b>*NOTE: Masks and sealed communion supplies are available, for those who desire them, in the foyer.</b>	

# Upcoming Events

**Golf Cart Shuttle Drivers:** pick up your fair tickets TODAY in the secretary's office

**Aug. 8, 6p, Ladies' Fellowship**, fellowship hall. All are welcome. Will be packing OCC Shoeboxes. Asking for the following donations: pencils, pencil sharpeners, large erasers, colored pencils, toothbrushes. Items can be placed in the Ladies' Fellowship bin in the workroom, or give to Marsha Jones, or Patty Burnett. Donations for shipping (\$10 per box), can be given to Janet Barnes.

**Sept. 11, Starting Ladies' Bible Study : The Book of Ruth, 6-8p** in the conference room, Sign up at the Registration Station.



With **Covid** starting to rise again, I want to remind everyone that if you are not feeling well in the least little bit, please stay home and worship with us on Facebook or YouTube. Let's all be responsible to keep God's house and God's people

healthy! God bless you all! *Gary Cline, Chairman of the Elders*

**Men's Bible Study** will not meet the month of August. We will pick up again Wednesday, September 7, at 7p in the Fellowship Hall

**Addresses for the Military & College Students Needed ASAP for Ladies' Fellowship.** Please leave in secretary's mailbox.

**Aug. 20, 6-8p Ripley Church-Wide Back to School Pool Party**, at the "James L. Crissey Memorial Pool" in Millersburg..



**Auditorium Doors** - When entering or exiting the auditorium, please do not allow the door to swing freely; slow the door behind you. This will eliminate noise and the potential to hit someone in the hallway.