

## FOR OUR GUESTS

---

We are glad you chose to worship with us today! We want to make your experience with us as easy and enjoyable as possible. The following information will help you to know what to expect today.

### Please take advantage of our children's programs:

#### Nursery (ages 0 through 2 yrs.)

A staffed, teaching nursery is located out the auditorium doors to the right.

#### Jesus' Farm (Ages 3 yrs. - K)

Jesus Farm is our pre-school program, offered during both hours, to help children know that God loves & cares for us. Every activity is geared to the child's learning level. It is located out the auditorium doors to the left. Your child may be checked in at the wagon.

#### rEVOLve (Grades 1 - 5)

rEVOLve is our elementary-age program located in the lower level of the fellowship hall. Bring your child down at 9:00 for Sunday School. Children will head to the lower level and enter a time of worship & an environment to develop a relationship with Jesus Christ through different activities.

**The Offering** - It is a privilege to give back to God a portion of the material blessings He has given us. Offering boxes are located on the walls at the back of the auditorium or you can give online @ [ripleycoc.com](http://ripleycoc.com).

**Communion** - We choose to offer the Lords' Supper each Sunday for all Christians to share. This is done to provide an opportunity to obey Christ to commune "in remembrance" of His death on the cross. Use this quiet time to draw close to the sacrificial Savior. Emblems can be picked up at the table in the foyer.

**Decision and Dedication** - Times for public responses to God are included in our worship. If you believe that Jesus is the Son of God, has the power to be your Savior, and has the right to be your Lord, this is an invitation for you to come to the front at the invitation song to announce your belief publicly and to

accept Christ by immersion in water (baptism). If you are an immersed believer in Jesus, and desire to be an active member of this body of believers, then come to affirm your faith publicly and express that desire. Responses for rededication and prayer are also encouraged by coming to the front at the invitation song.

If you would like further information about either of these decisions, feel free to schedule an appointment with one of our staff members. Individuals may make these decisions throughout the week and need not take place in the worship service.

*If you need additional information or assistance, please ask an usher or greeter. They are here to assist you.*

## Ripley Church of Christ

9:00 am Sunday School

10:15 am Worship

Ph. 330-567-2320

[www.ripleycoc.com](http://www.ripleycoc.com)

For more detailed information about our church, service opportunities or ministries, stop by our welcome center or visit us on the web. You'll find access to sermons, resources, calendar, and more.

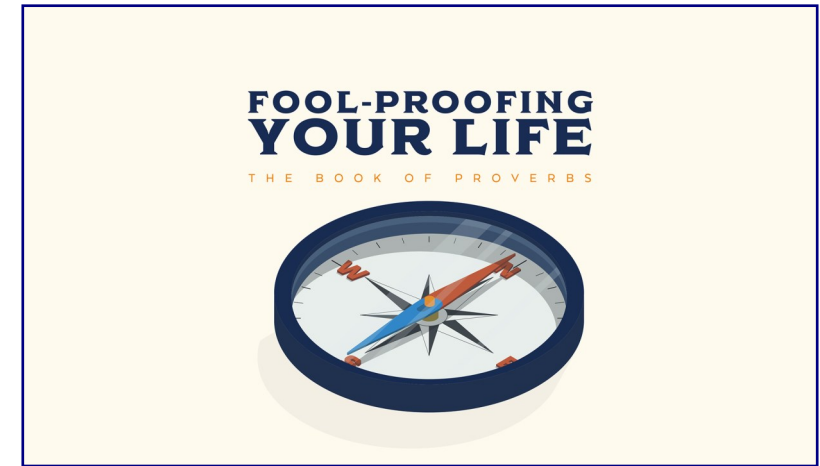

May 8, 2022

Tom Benter  
Senior Minister

Mike South  
Youth Minister

Jeremiah Stivers  
Associate Minister

Ariel Stivers  
Children's Ministry Coordinator

# Sermon Notes

## Fool Proofing Your Life Week 2 Qualities Of A Wise Family Proverbs 5, 13, 22

### Three Qualities Of A Wise Family

1. A wise family consists of a marriage that continually \_\_\_\_\_ each other.

-Proverbs 5:15-18

2. A wise family teaches the \_\_\_\_\_.

-Proverbs 22:6

1. E\_\_\_\_\_

2. I\_\_\_\_\_

3. D\_\_\_\_\_

3. A wise family \_\_\_\_\_ their parents.

-Proverbs 13:1, Ephesians 6:1-2



## This Week

Today:	9:00 a	Sunday School
	10:15 a	Worship
	6-8:00 p	No Youth Launch
	6-8:00 p	No Ladies' Bible Study
Tue:		American Heritage Girls' Court of Honor
Wed:	7:00 p	Men's Bible Study
	7:00 p	Intermittent Fasting (Faith-Fast-Friends)
Fri:	5-9:00 p	Parents' Night Out

## ABF Classes / Locations

### 9:00a

Adult Study, *Acts* F3  
Youth Sunday School, Basement  
Women's Class; *Next Door Savior* by Max Lucado., Conf. Room  
College / Young Adults, Choir Room  
Ladies' Class; *She Works His Way*, F2

### 6-8p Sunday

Ladies' Study: *Gospel of Mark*, Conf. Room

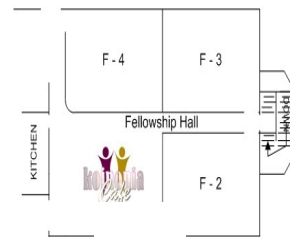

May 1 Giving \$10,057.72 Budget \$7,692.31



**\*NOTE: Masks and communion supplies are available in the foyer as you enter.**

# Upcoming Events

## Bottles for Pregnancy Care Center Due Today

**Sunday Night Ladies' Bible Study** will be meeting May 15, 22, 29 but will *not* be meeting in June. Exploring summer meeting options; let Debbi know your thoughts/availability (330.231.0378).

**"Parent's Night Out"**, Friday, May 13<sup>th</sup> from 5pm-9pm. This is a "by donation" fundraiser for the youth going on the AZ Mission trip. Drop your children off at the church and enjoy a kid free night! Snacks will be provided but kids may pack a dinner. Please sign up to ensure we have enough helpers.

## What: A Ladies Bible Study Luncheon

Who: Ripley Women of all ages who are currently in a Ladies' Bible Study or are interested in joining one.

Why: to share a meal and get to know other ladies in the church and also to hear about the women's Bible studies we have at Ripley

Where: Fellowship Hall after services

When: Sunday, May 15

We are asking that you bring a side dish or dessert to share.

Please sign up in the workroom. Any questions, contact Keri Tipton at 330-347-8695

**"Sneak Peek Sunday"**, May 15<sup>th</sup>. All 5<sup>th</sup>-7<sup>th</sup> graders are invited to join Mike and Sarah South for Mini Golf. Meet at the church at 2:30pm. Just need money for fast food dinner and ice cream! Afterwards, all 5<sup>th</sup> graders stick around for Launch Youth Group that night.

**Family Game Night** Friday, May 20. 6p until? Everyone welcome! Bring a snack to share and your favorite board games and card games! A great time to invite a family or friends! Sign up @ the Registration Station. Questions? Contact Debbi at 330.231.0378

**If you will have a 2022 High School or College graduate, please contact the Ripley office ASAP, if you haven't yet.**

**Auditorium Doors** - When entering or exiting the auditorium, please do not allow the door to swing freely; slow the door behind you. This will eliminate noise and the potential to hit someone in the hallway.